

Procedure for DiaPat[®]-NDif test

Second morning urine is required for the DiaPat[®]-NDif test, (second toilet visit of the day).

Sampling: Open the DiaPat[®] urine cup. Discard the first void urine and fill the DiaPat[®] urine cup with midstream urine.



midstream urine



Have urine monovette and canula ready



Pull off sealing cap



Place canula on urine monovette



Soak up urine into monovette, make sure to pull out piston completely

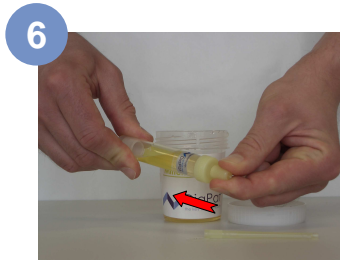

Ensure safe fitting of sealing cap



Break piston at predetermined breaking point



Freeze filled urine monovette (urine sample) and cooling element separately after sampling



Store urine sample and cooling Element for a minimum of **24 hours** in a ***freezer compartment (-18°C) until shipment



Notify pick-up service after 24 hours and place monovette into cooling element immediately before shipment



Ensure to screw on cap on cooling Element tightly



Insert cooling element into styrofoam box and save cover with elastic band



Insert sample and documents into packet and seal it with the badges